

SIMPLE INTEGRATION  
AND INTELLIGENT  
LIGHT SWITCHING

# Switch Module for brand switches – International

HmIP-BSM-I

The Switch Module for brand switches – International allows lighting to be controlled the smart and simple way. The invisible flush-mounted solution can be integrated directly into many switch series with adapters, and blends perfectly into the existing switch design. Use the Homematic IP app to conveniently set up and control your lights via your smartphone, time profile or pushbutton.

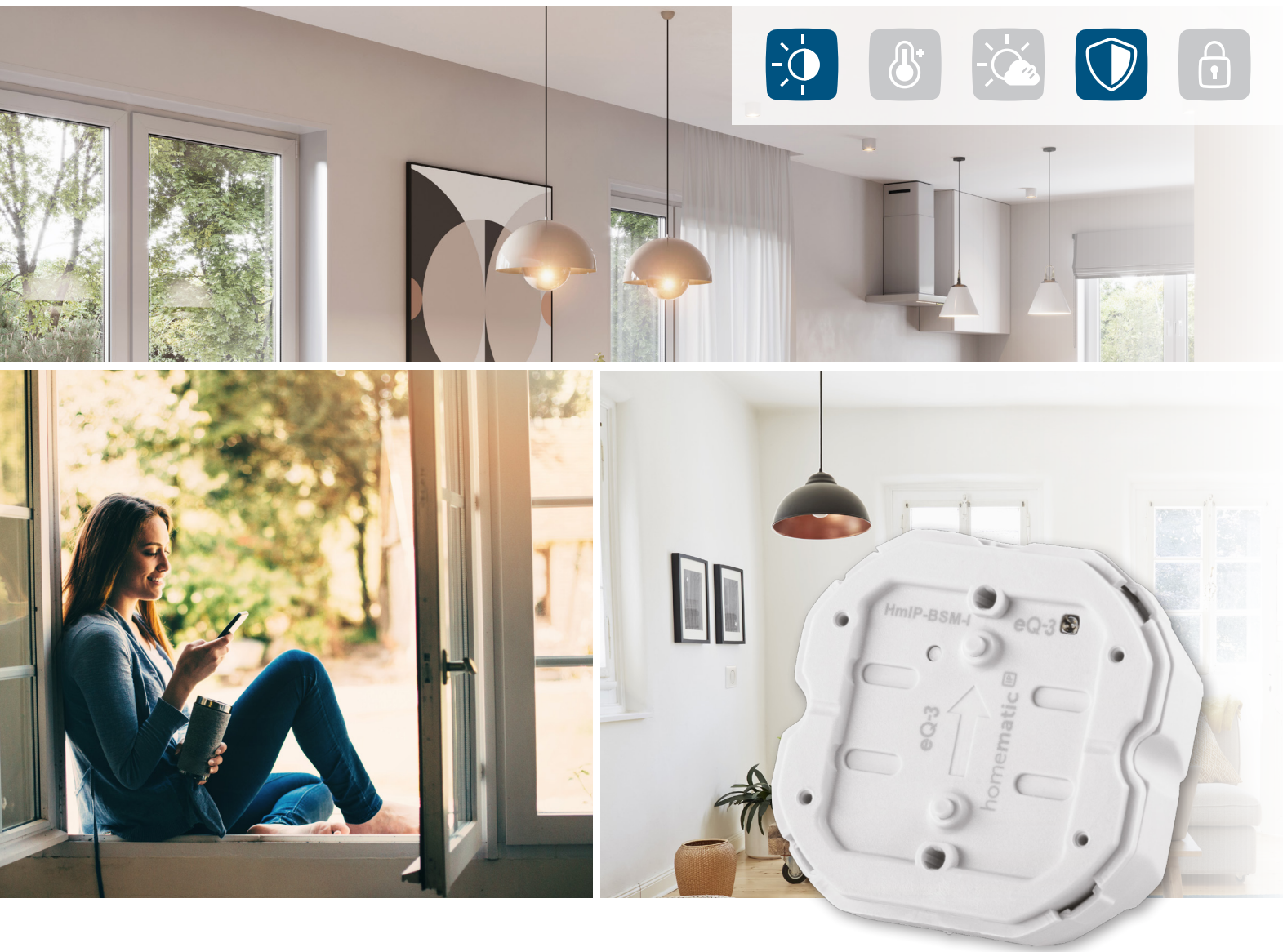

homematic <sup>IP</sup>  
Smart living. Simply exciting.

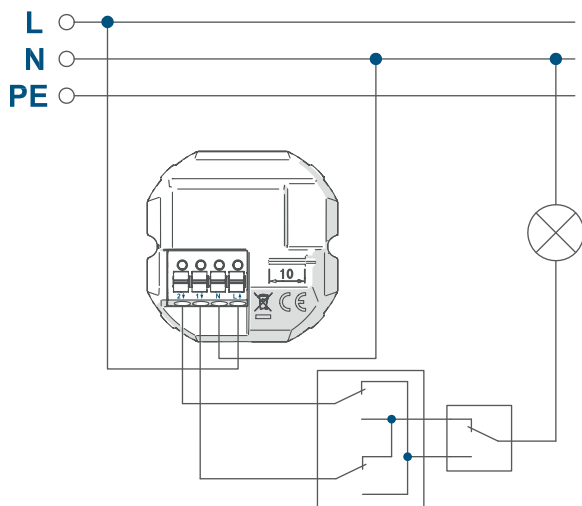

Example: Cross-connection  
A neutral conductor is required for installation

## INTELLIGENT LIGHT SWITCHING

The connected lights can be conveniently switched on and off to create the ideal lighting mood in your smart home.

The switch module can be used not just for switching off but also for intermediate and changeover switching, and recognises the switching status of all switching points by means of the integrated measuring function.

## JUST GET STARTED

The compact design allows installation in standard flush-mounted boxes, with no special electronics box required. The screwless terminals make wiring particularly easy and secure. The connection is identical to a manual switch and so can be done by any installer.

## TECHNICAL SPECIFICATIONS

Supply voltage	230 V/50 Hz
Current consumption	6 A max.
Power consumption in standby	0.2 W
Minimum load for cross-connection or two-way circuits	1 W
Maximum switching capacity	1380 W
Load type	Ohmic load
Relay	Changeover contact
Cable type and cross section	rigid and flexible cable, 0.75 - 2.5 mm <sup>2</sup>
Installation	only in Legrand Batibox-type switch boxes conforming to DIN 49073-1, and Agro flush-mounted back boxes
Degree of protection	IP20
Ambient temperature	-5 to +40 °C
Dimensions (W x H x D)	52 x 52 x 31 mm
Weight	55 g
Radio frequency band	868.0-868.6 MHz 869.4-869.65 MHz
Typical range in open space	280 m

## INVISIBLE INSTALLATION

Integration into existing switch series is very easy by using the existing frames and rockers. With a corresponding adapter\*, the switch module can be integrated into many leading manufacturers' (e.g. Legrand, Schneider Electric and Feller) popular switch series. An overview of the compatible manufacturers is available at [www.homematic-ip.com](http://www.homematic-ip.com).

\*Adapter must be purchased separately

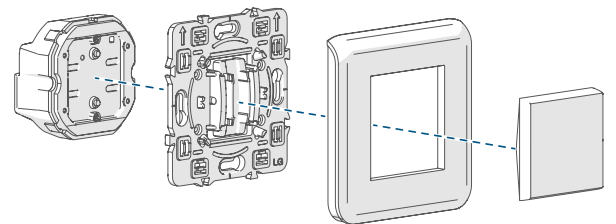

Homematic IP Switch Module for brand switches    Suitable adapter    Frame (example)    Rocker (example)

## FLEXIBLE OPERATION

- ✓ Directly via the existing switch series
- ✓ Wirelessly using Homematic IP push-buttons, or remote controls or motion detectors
- ✓ At any time via the Homematic IP app
- ✓ Via adjustable time profiles to automatic switch the lighting on or off at the desired time
- ✓ Easy operation via voice control (using Amazon Alexa or Google Assistant)

Operation requires connection to one of the following solutions:

- Homematic IP access point with free smartphone app and free cloud service
- Third-party partner solutions

## LOGISTICS DATA

Product reference	155999A0A
EAN code	4047976559992
Short description	HmIP-BSM-I
Packing unit	90
Packing dimensions	122 x 112 x 48 mm
Weight incl. packaging	146.6 g

## PACKAGE CONTENTS

Homematic IP switching module for brand switches – international  
Operating manual